

### PKH.EN.M.I

Tough pneumatically driven brass ball valve with 2-parts housing.



#### SIZE

DN15 (1/4") to DN50 (3")

#### CONNECTION

Internal thread UNI EN 10226 (DIN ISO 7/1)  
Mounting flange ISO 5211

#### NOMINAL PRESSURE

PN40 (1/4") to PN16 (3")

#### TEMPERATURE RANGE

From -20° to +150°C

#### MATERIALS

Body: Brass CW 617 N UNI EN 12165  
Ball: Brass, hart chrome plated CW 614 N UNI EN 12164  
Ball seal: PTFE  
Stem: Brass, hart chrome plated CW 614 N UNI EN 12164  
Stem seal: PTFE  
O-Ring: Elastomer  
Gland: Brass CW 614 N UNI EN 12164

#### FLOW DIRECTION

Random

#### MOUNTING POSITION

See mounting reference for industrial valves.

#### FLOW MEDIUM

Neutral gases and fluids. For aggressive medium see material resistance table. Medium which lead to an increase of operating torque could require other actuator size.

#### OPERATION METHOD (Standard)

Pneumatic actuators, double- or single acting, spring open (NO) or spring closed (NC) version.

#### CONTROL MEDIUM

Compressed air or inert gases acc. PNEUROP/ISO class 4, other control medium on request.

#### CONTROL PRESSURE

5,5 bar, other control pressure on request.

#### PNEUMATIC CONTROL

With either direct-mounted (NAMUR) or separate 3/2- or 5/2-way control valve or positioner.

#### OPTIONS AND ACCESSORIES

Limit switch box with mechanical microswitches or inductive sensors.

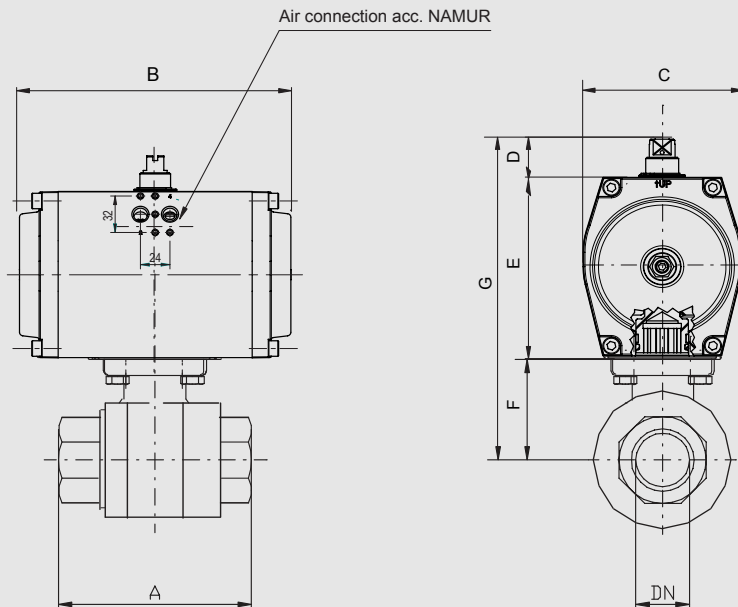

PKH.EN.M.I	Nominal width [mm / "]		max. press. [bar]	M(1) + 30% [Nm]	Flange	square	Pneumatic actuator	Dimensions [mm] and weight [kg]							Order code (2)	
	DN	Rp						PN	A	B	C	D	E	F		G
double acting	8	1/4"	40	2,8	F03	9	GTKB.43x90	75	116	61,5	30	65	38	133	1,10	PKH.EN.M.I.DN08.43.DA.100
	10	3/8"	40	2,8	F03	9	GTKB.43x90	75	116	61,5	30	65	38	133	1,00	PKH.EN.M.I.DN10.43.DA.100
	15	1/2"	40	4,2	F03	9	GTKB.43x90	75	116	61,5	30	65	38	133	1,00	PKH.EN.M.I.DN15.43.DA.100
	20	3/4"	40	5,6	F03	9	GTKB.43x90	80	116	61,5	30	65	40,5	135,5	1,10	PKH.EN.M.I.DN20.43.DA.100
	25	1"	40	8,4	F03/F04	9	GTKB.43x90	90	116	61,5	30	65	44	139	1,40	PKH.EN.M.I.DN25.43.DA.100
	32	1 1/4"	40	9,8	F04/F05	11	GTKB.44x90	110	116	61,5	30	65	55	150	1,70	PKH.EN.M.I.DN32.44.DA.100
	40	1 1/2"	25	13	F04/F05	11	GTKB.52x90	120	133	68,5	30	74	61,5	165,5	2,60	PKH.EN.M.I.DN40.52.DA.100
	50	2"	25	25	F05	14	GTKB.63x90	140	137	80	30	88	73	191	4,45	PKH.EN.M.I.DN50.63.DA.100
	65	2 1/2"	16	38	F07	14	GTKB.75x90	155	161	92,5	30	100	82,75	212,95	5,50	PKH.EN.M.I.DN65.75.DA.100
80	3"	16	46	F07	14	GTKB.75x90	182	161	92,5	30	100	94,5	224,5	8,20	PKH.EN.M.I.DN80.75.DA.100	
single acting	8	1/4"	40	2,8	F03	9	GTKB.43x90.06	75	116	61,5	30	65	38	133	1,20	PKH.EN.M.I.DN08.43.xx.100
	10	3/8"	40	2,8	F03	9	GTKB.43x90.06	75	116	61,5	30	65	38	133	1,10	PKH.EN.M.I.DN10.43.xx.100
	15	1/2"	40	4,2	F03	9	GTKB.52x90.08	75	133	68,5	30	74	38	142	1,40	PKH.EN.M.I.DN15.52.xx.100
	20	3/4"	40	5,6	F03	9	GTKB.52x90.08	80	133	68,5	30	74	40,5	144,5	1,50	PKH.EN.M.I.DN20.52.xx.100
	25	1"	40	8,4	F03/F04	9	GTKB.52x90.08	90	133	68,5	30	74	44	148	1,80	PKH.EN.M.I.DN25.52.xx.100
	32	1 1/4"	40	9,8	F04/F05	11	GTKB.63x90.08	110	137	80	30	88	55	173	2,90	PKH.EN.M.I.DN32.63.xx.100
	40	1 1/2"	25	13	F04/F05	11	GTKB.63x90.08	120	137	80	30	88	61,5	179,5	3,30	PKH.EN.M.I.DN40.63.xx.100
	50	2"	25	25	F05	14	GTKB.83x90.08	140	180	92,5	30	100	73	203	6,00	PKH.EN.M.I.DN50.83.xx.100
	65	2 1/2"	16	38	F07	14	GTKB.92x90.10	155	209	110,5	30	117	82,75	229,75	7,40	PKH.EN.M.I.DN65.92.xx.100
80	3"	16	46	F07	14	GTKB.92x90.10	182	209	110,5	30	117	94,5	241,5	10,5	PKH.EN.M.I.DN80.92.xx.100	

(1) = Max. ball valve torque + 30%. (2) = Placeholder for function version NC (normal closed) or NO (normal open).